



A TRICK 40 ECO+



PLEASE READ BEFORE USE

Do not pour oil into lower cover.

Always keep upright.

Tilting machine will case damage.

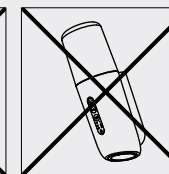
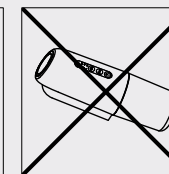
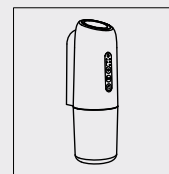

CAUTIONS

To avoid casualties and property loss, please comply with the following.



Prohibited

WARNING

May cause
electric shock
or fire hazard.

INSTALLING

1. Do not use in an unsafe or faulty outlet.
2. Do not install the device at a place where children can touch.
3. Do not install the device at a plug where device remains loose.
4. Do not tilt the device.
5. Keep the device away from fire and heat source, do not store flammable and explosive materials around the device.
6. Do not use device in high temperature or wet environment.
7. Do not use flammable, explosive, corrosive and other hazardous solvents in the device.



Note

May cause
personal injury
or property
damage.

NECESSARY WHEN INSTALLING

1. **Important to have proper airflow when diffusing fragrance oils.** Lack of airflow can lead to wet fallout which can damage varnish or painted surfaces.
2. Ensure the diffuser is plugged in securely.
3. Install the device in a space with adequate ventilation.
4. Do not block the atomizing port when the device is working.
5. Do not spill water or conductive, corrosive liquid on the inside or outside of device.
6. Unplug the diffuser in extreme weather.

PRODUCT INFORMATION

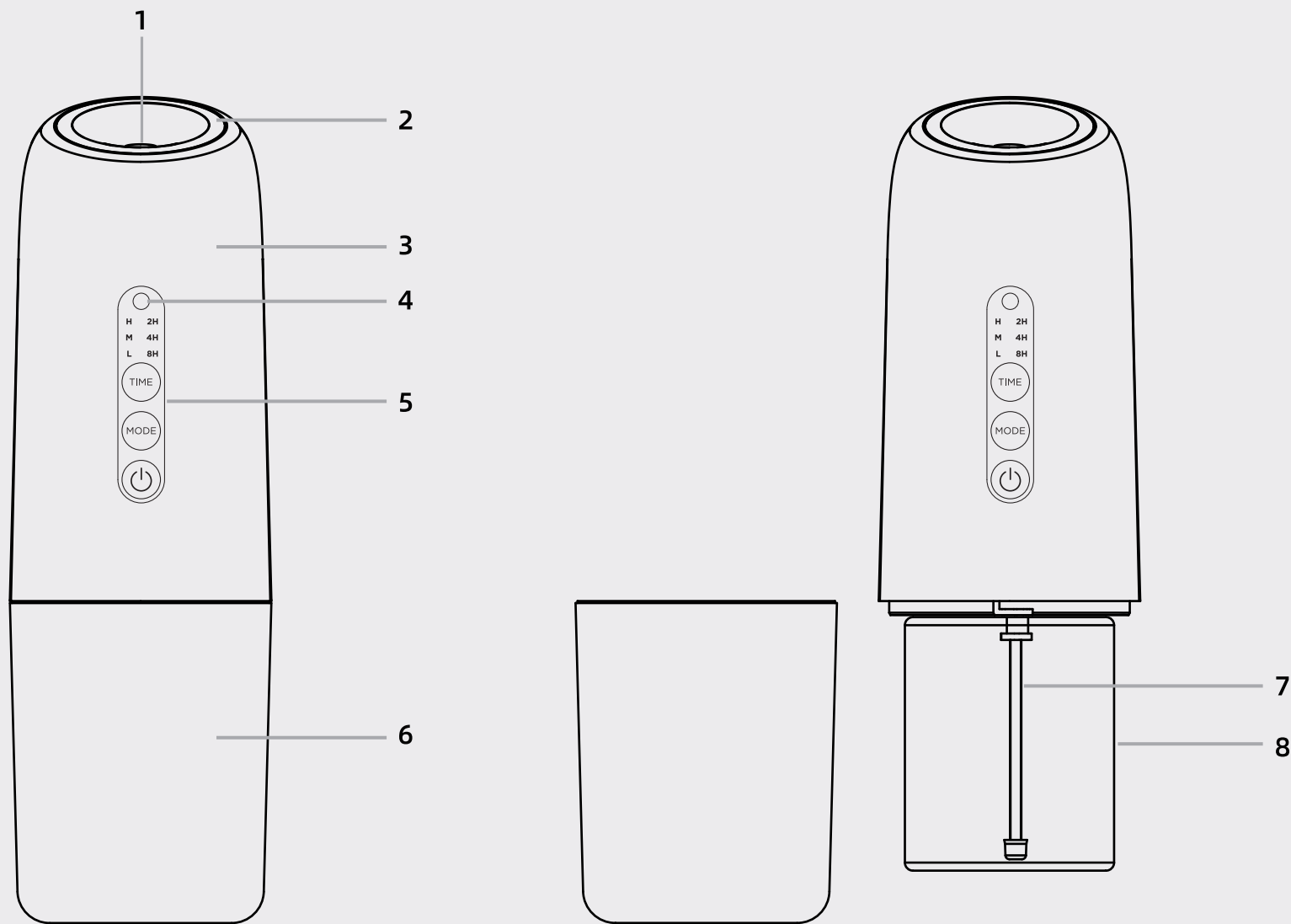

- 1- Mist outlet
- 2- Night light
- 3- Upper shell
- 4- Lighting sensor

- 5- Touch control button
- 6- Lower cover
- 7- Atomizing pipe
- 8- Bottle

SPECIFICATIONS

Model No.	D1
SIZE	65mm X 72.5mm X 205mm / 2.56”W X 2.85”L X 8.07”H
Voltage	110-240V
Power	3W
Weight	350g
Capacity	100ml

SET UP

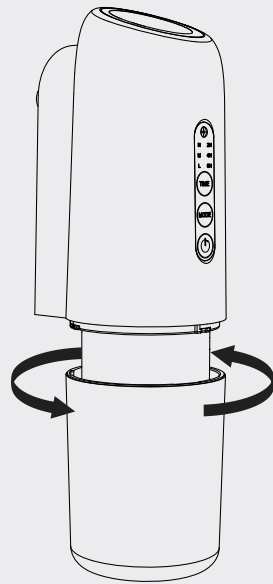

①

Unscrew the lower cover.

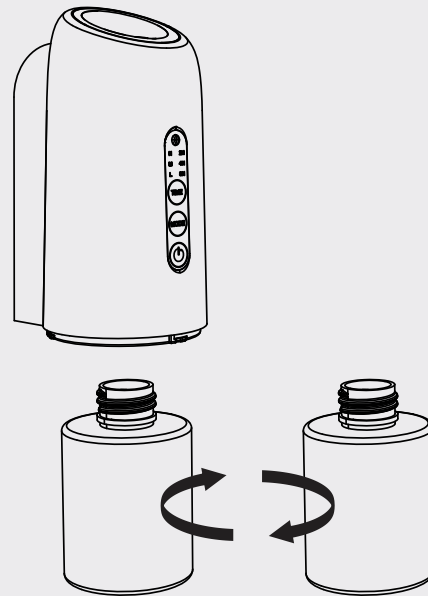

②

Unscrew oil bottle and refill/change oil.

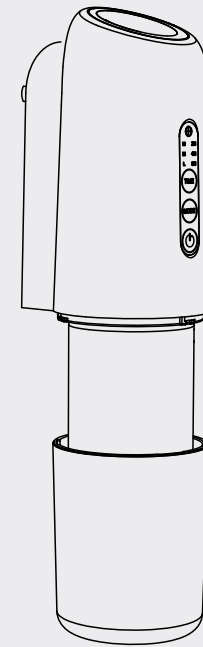

③

Screw the oil bottle in place and close lower cover.

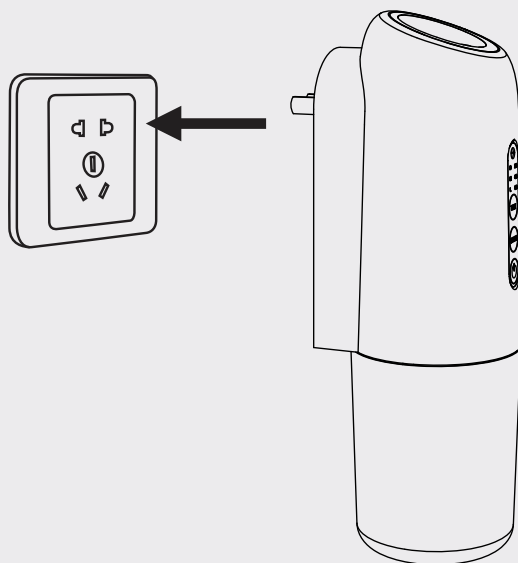

④

Plug in socket and choose working level and time. See next page for operating instructions.

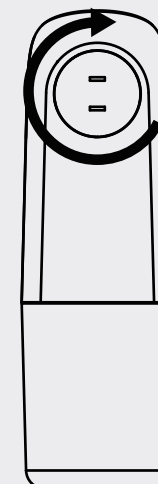
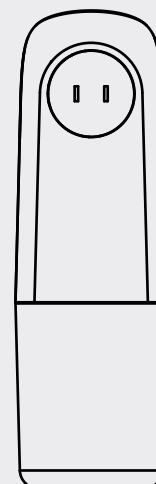
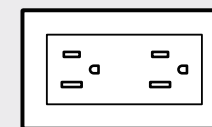
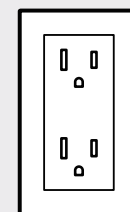

Note

Make sure that unit is always upright to avoid leakage. Rotate plug prongs if necessary.

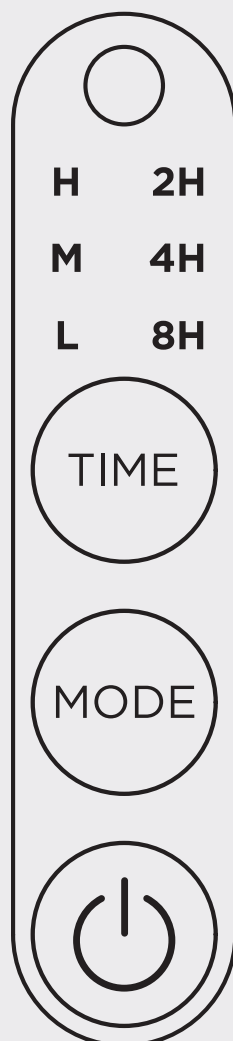

CONTROL



ON/OFF

Press and hold for 2 seconds to turn the diffuser on or off.
Press once to turn the ambient night light on or off.



INTENSITY SETTING

H: Diffusing for 25 seconds and pausing for 60 seconds.

M: Diffusing for 20 seconds and pausing for 120 seconds.

L: Diffusing for 10 seconds and pausing for 240 seconds.



WORKING TIME SETTING

2H: Indicates the diffuser will automatically turn off after 2 hours.

4H: Indicates the diffuser will automatically turn off after 4 hours.

8H: Indicates the diffuser will automatically turn off after 8 hours.

If you don't choose the working time, the diffuser will keep running. In order to save the lifespan of the pump, We do not recommend running this machine continuously.



LIGHT SENSOR

Control the night light with daylight or artificial light.

It will automatically switch on the lighting when enough darkness is sensed by the sensor.

It will automatically switch off the lighting when enough light is sensed by the sensor.

If you want to keep the light on or off, you can press  once to turn the ambient light on or off.

If you want to set back to sensor control mode, just unplug and plug in again.

MACHINE CLEANING & MAINTENANCE

Your scent diffuser should be cleaned every 1-2 months or when switching fragrance to ensure optimal performance.

Before cleaning your machine, ensure that the machine is unplugged.

Cleaning steps

1. Unscrew the lower casing and unscrew the oil bottle.
2. Let the oil bottle soak in 99% rubbing alcohol for 15min.
3. Fill the oil bottle with 20ml of rubbing alcohol and let the machine run for 5min.
4. Unscrew the oil bottle, empty it, and let it air-dry for 15min.
5. Using a cotton swab clean the tight spots and corners of the diffuser to make sure that no spots are left dirty.

Replacing the nozzle

1. To change the nozzle, unplug the diffuser, remove the bottle of oil, and carefully pull out the clear tube. Gently pull out the white nozzle by wiggling it gently using a pair of tweezers.
2. Replace it with a new nozzle and ensure the nozzle is pressed very firmly into the top of the diffuser.

Storage

1. Always turn off or unplug the diffuser when not in use.
2. Remove the bottle of oil when storing or transporting the diffuser.
3. Store the diffuser in a dry and clean place.

TROUBLESHOOT

Before having the machine repaired, please try to diagnose the problem with the following:

Problem	Solution
No Diffusion	<ul style="list-style-type: none">• If there is no diffusion or it is weak, replace a new nozzle and check.• Check if the power is ON or OFF.• Check oil level in bottle.• Is the machine in its "not working period"?• Check if the air pump is damaged. If yes, please contact the seller for replacing it with a new pump.
Diffusion is weak	<ul style="list-style-type: none">• Check if the gasket is damaged or loose. Please adjust it or replace it with a new one.• Check if the atomizer nozzle is clogged with oil or impurities. Clean it with 99% rubbing alcohol or replace the atomizer nozzle.
Oil is spilling in the lower cover	<ul style="list-style-type: none">• Check if the oil container is loose. If yes, please screw it in fully.

Oil is overflowing	<ul style="list-style-type: none">• Check if the gasket of the atomizing head is damaged. If yes, please replace it.• Please make sure the machine is in its vertical position.• Please sure sure the oil does not exceed the MAX line.
Night light not on automatically	<ul style="list-style-type: none">• Please check if the room is dark enough to be sensed by the sensor.• If it is turned off by power button, please unplug the diffuser and plug in again to set back to sensor control mode.

APP OPERATIONS AND SETTINGS

iPhone:

You can download the “**Smart Diffuser**” App from the **IOS Play Store** for advanced control. Once downloaded, connect to the diffuser by Bluetooth.

Through the app, you can create a more intense scenting schedule and adjust the intensity according to your preferences.

 You can also scan this QR code to download the **Smart Diffuser App. (IOS only)**

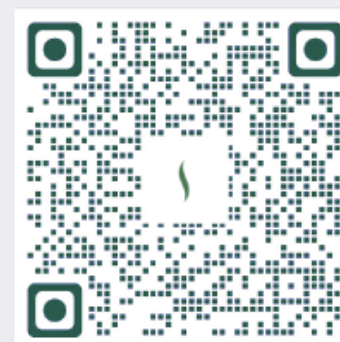

Android Phone:



You can download the “**Scent Mate**” App from the **Google Play Store** for advanced control.

 You can also scan this QR code to download the **Scent Mate App. (Google Play only)**

Scent Mate

Note:

Make sure that the location function of Bluetooth and mobile phone is enabled.

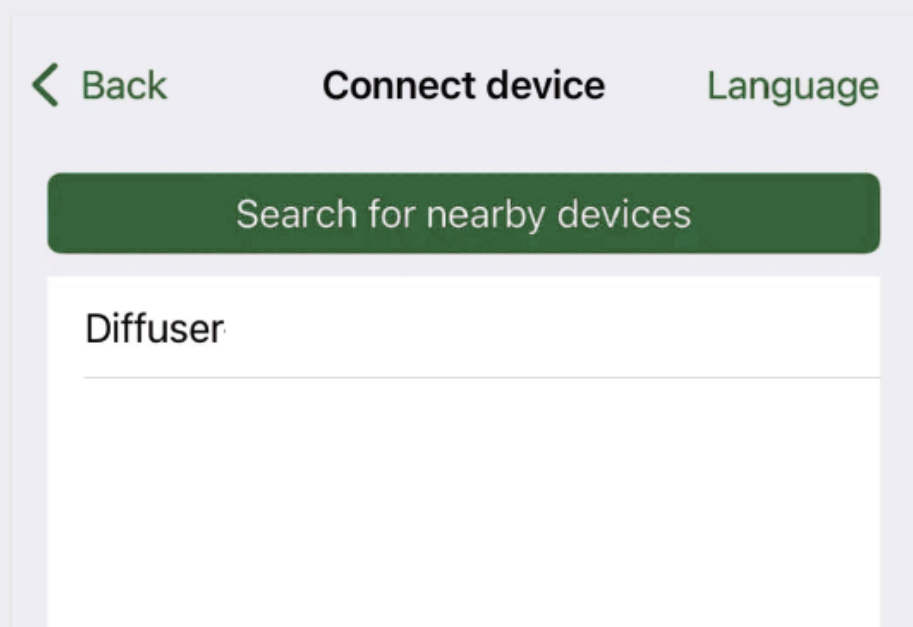

1. Open the the Smart Diffuser APP and select Search for nearby devices.

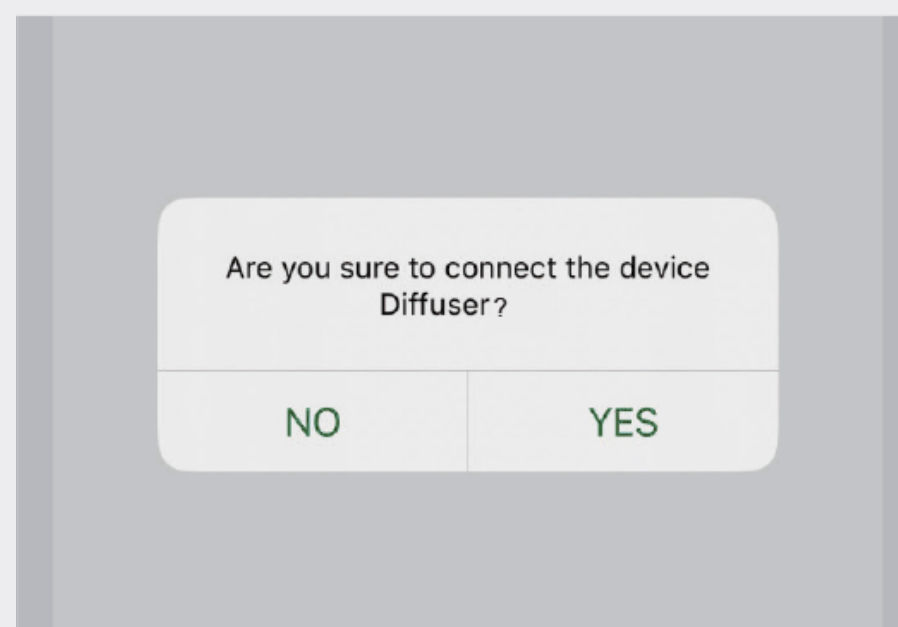

2. Connect to the device you selected.

APP OPERATIONS AND SETTINGS

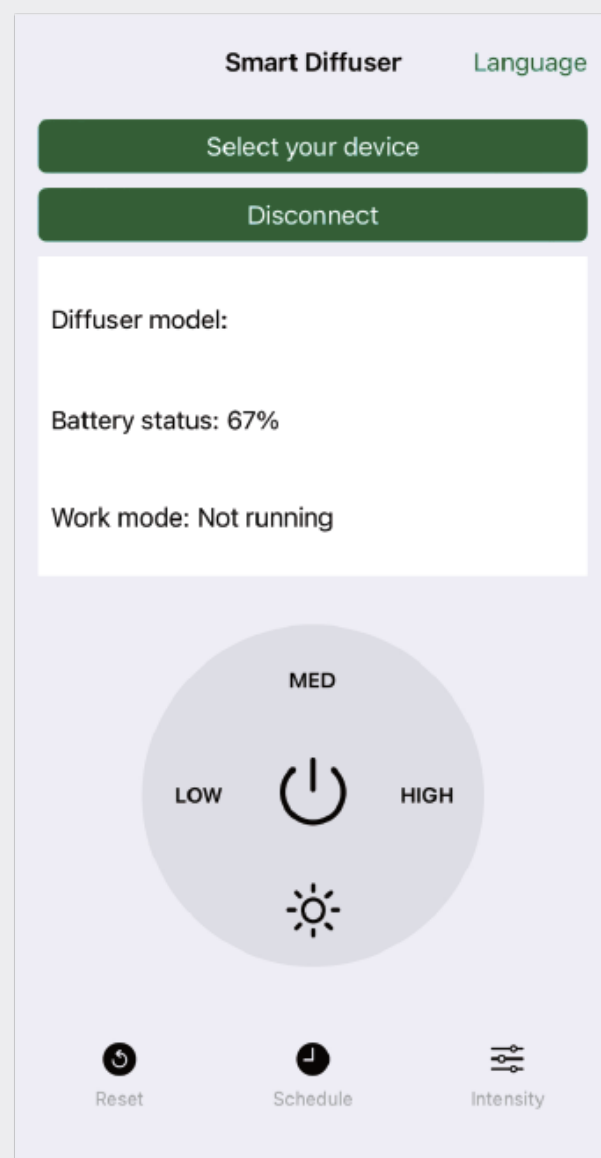

3. On the device control page, you can choose the diffusing levels and set the working time.

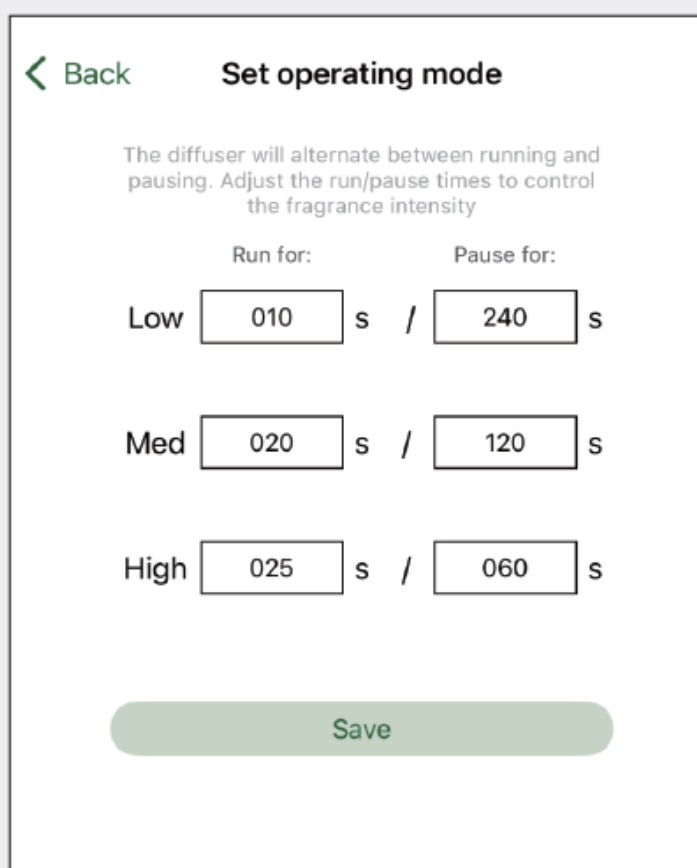

4. You can set the run/pause time to control the fragrance intensity.

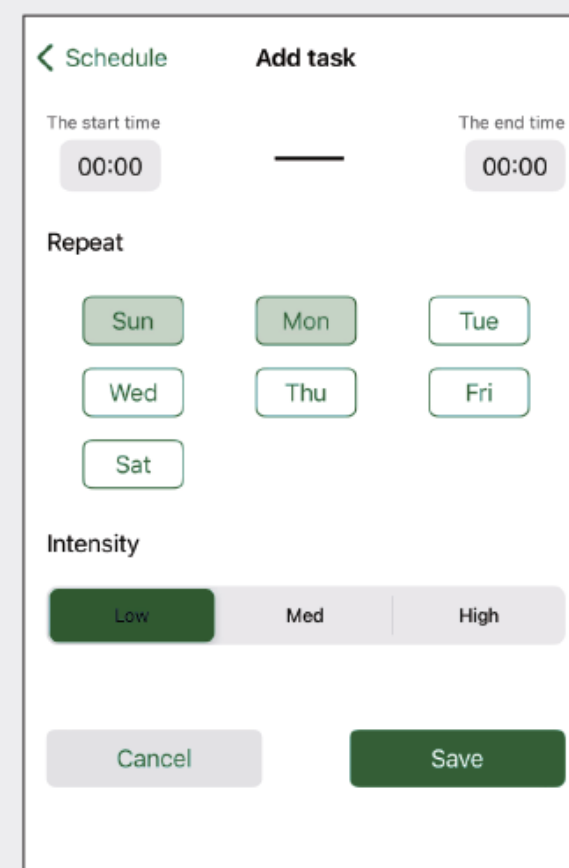

5. On the schedule page, you can set the hours of the day and the days of the week you want your diffuser to run.